

Number of connected lights:
Any number between 0 & 50 of Lopolight dimmable products can be connected to the same dimmer.

Full 0-100% control:
The dimmer varies the light output between 0 and 100%. It is not mandatory to use switch (thus shown in example #1) when controlling single function lights. Full dimming: turn knob counter clockwise. Full brightness: turn knob clockwise.

Example #1: Basic dimmable installation. (single function lights)

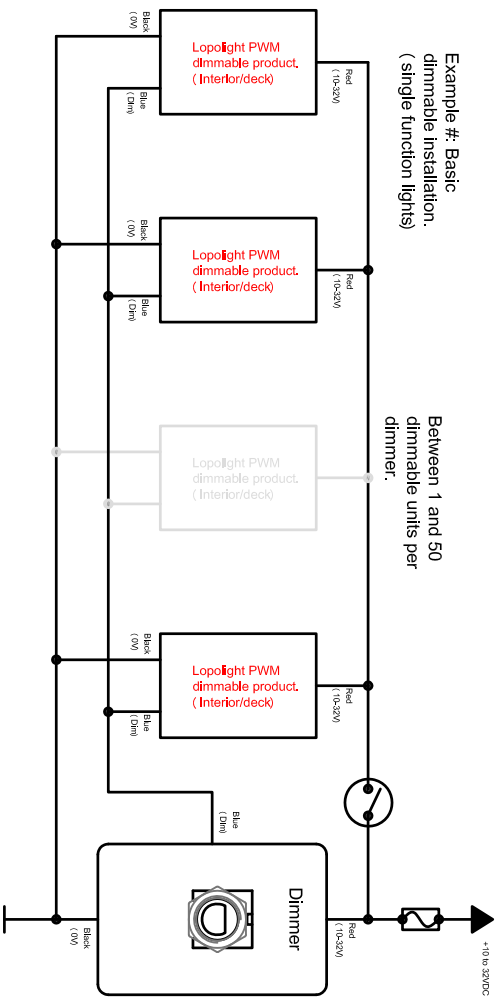

Suggested cabling:
Screened cable should be used for dimming signal wire when installing lights more than 20 meters away from dimming unit. The dimmer unit and the connected lights must share minus.

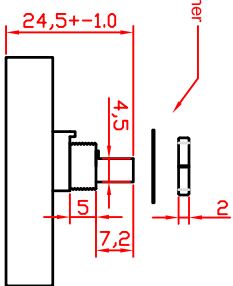

Potentiometer axel: Ø6 *4.5 "D" shape

Wire length: ~250mm

RED: +10 to 32 VDC

BLACK: 0V

BLUE: DIMMING SIGNAL

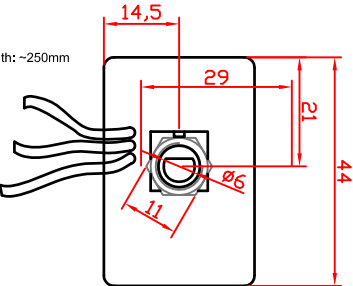

Example #2: Basic RED/WHITE dimmable installation.

Between 1 and 50 dimmable units per dimmer.

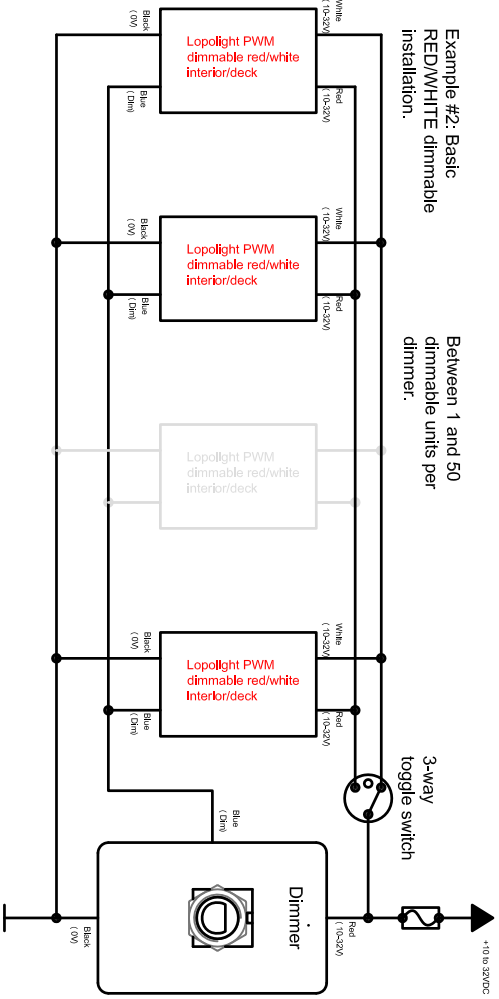

Lopolight P/N: 400-126
PWM Dimming unit
Mechanical and basic installation.

Drawing no.:	Rev.:	Drawing date:	Sign.:
1	1	260512	PHH
Scale:	Format:	Order number:	Sign.:
---	A3	270512	PHH
Material:		Tel.:	
		DS 2768 Fine	

Lopolight Apps

Ved Kædebo 12B, DK-2970 Høersholm
Tel: +45 32 48 50 30
Fax: +45 32 48 50 32
E-mail: info@lopolight.com
www.lopolight.com

Remark: File name: dimmer/Installation 1.0

This drawing is our property, and may not be reproduced or copied without our permission.